

1**2**

Ø 3 mm

Ø 3 mm

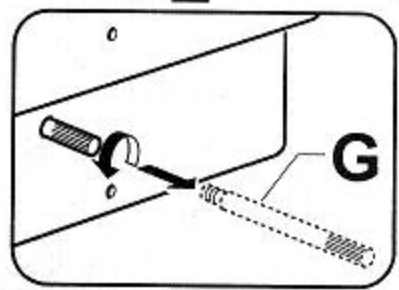
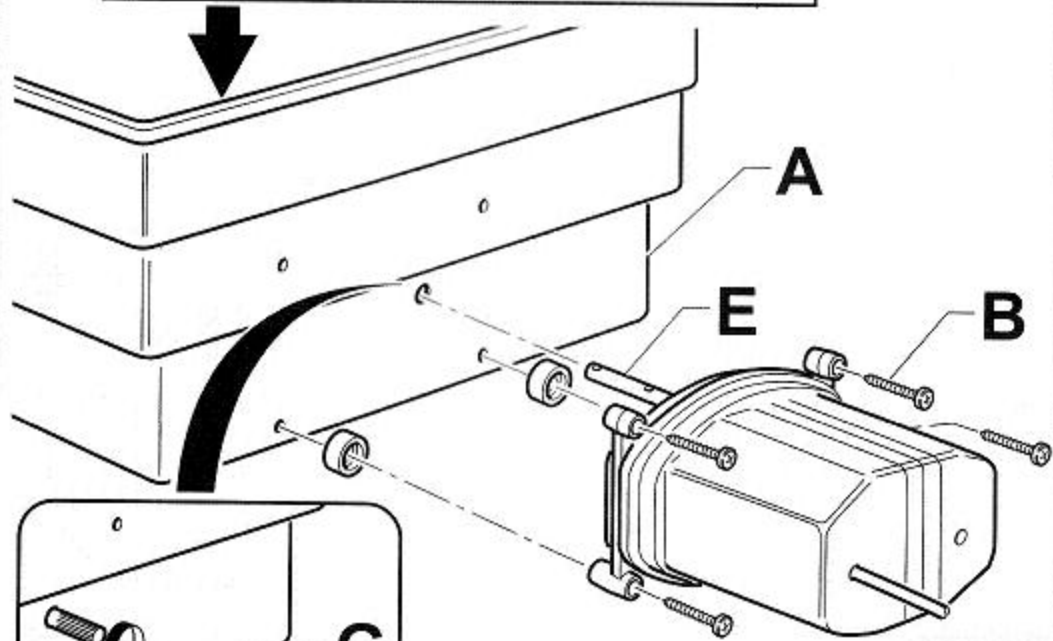
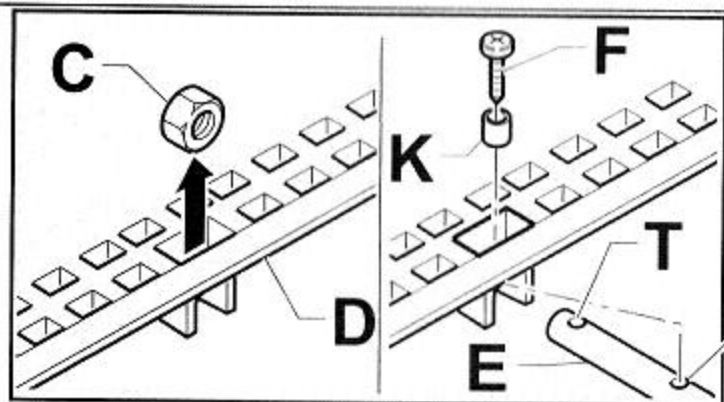
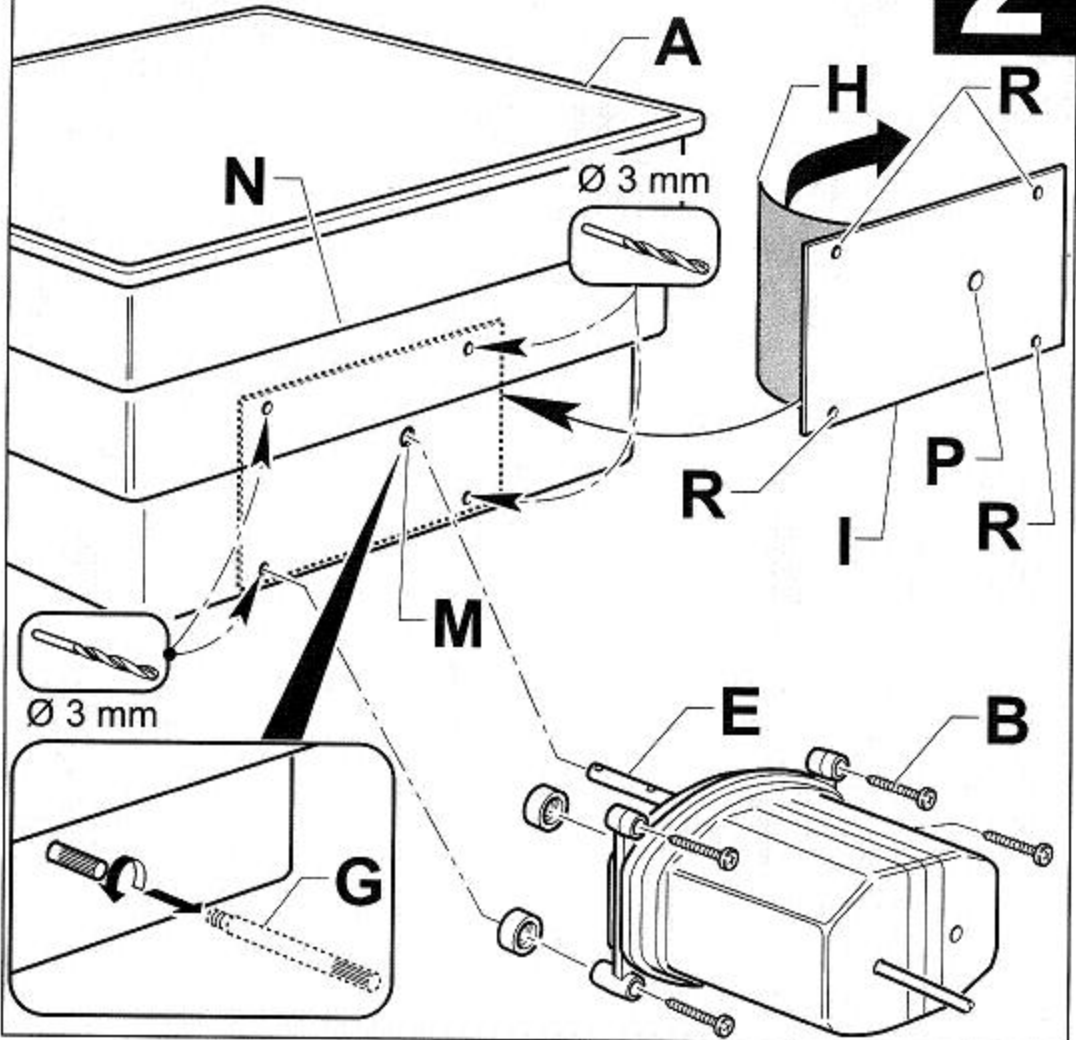
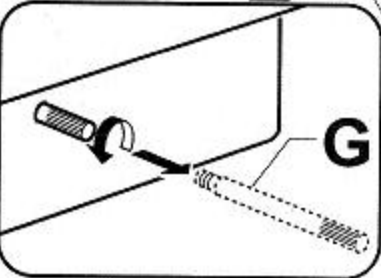
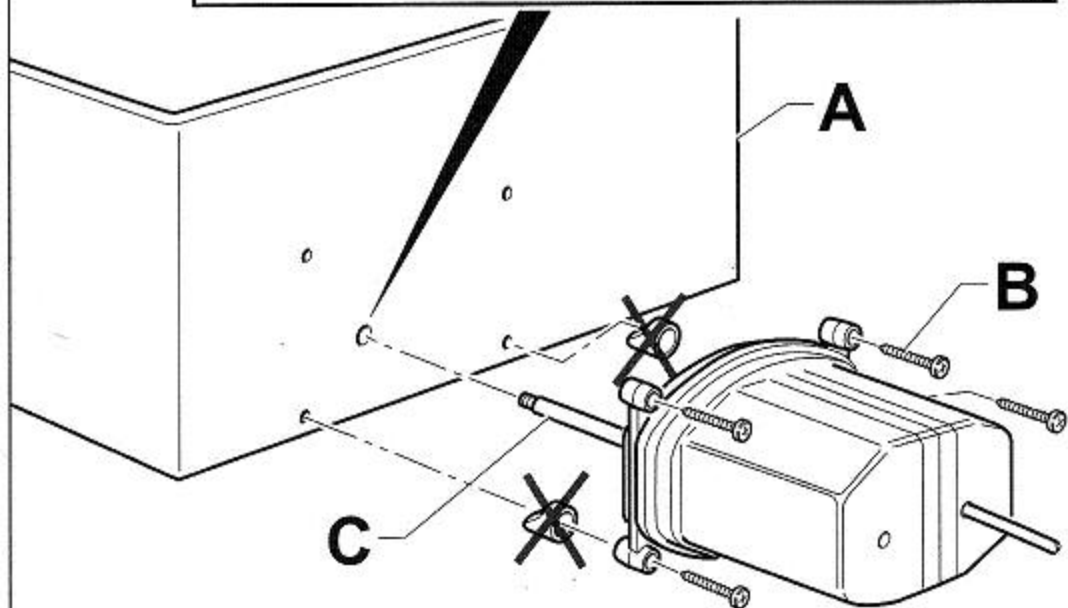
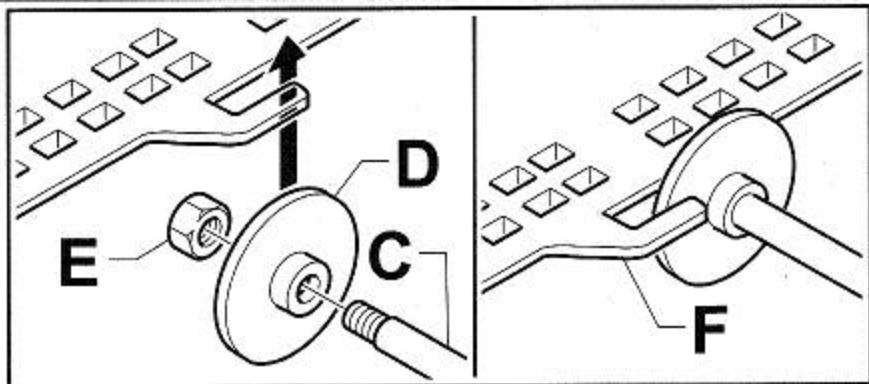
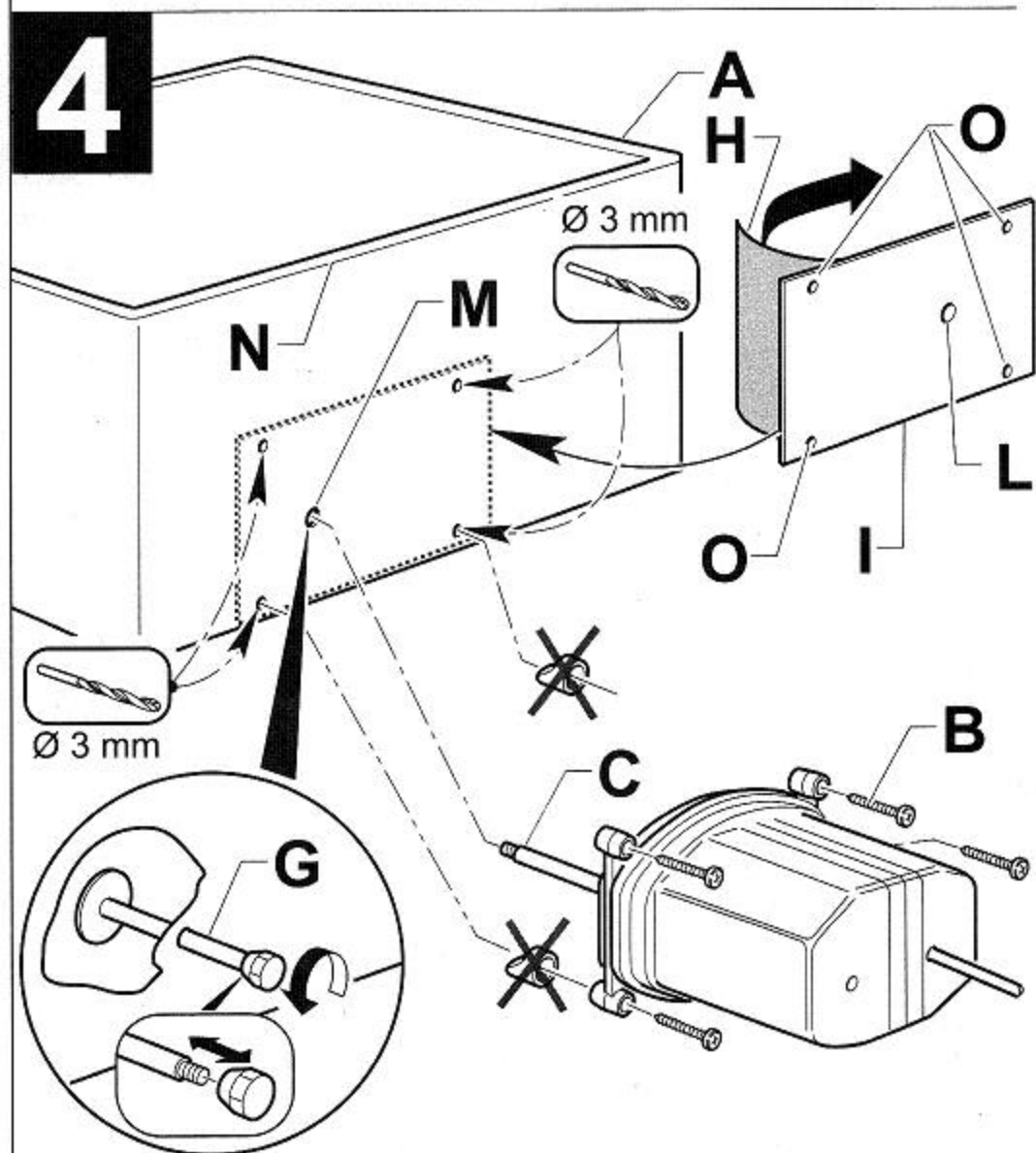

3**4**

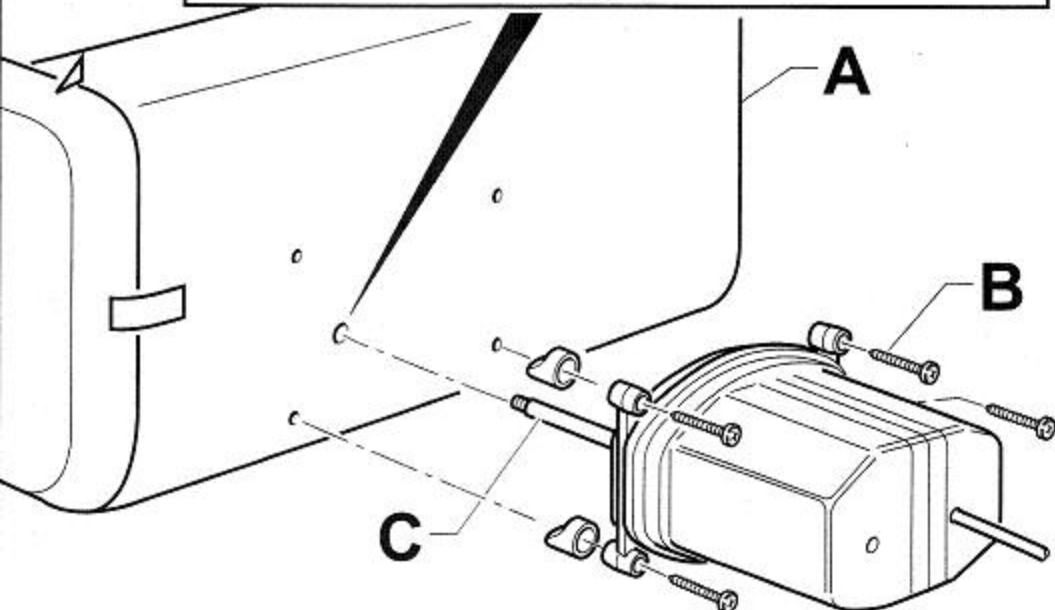
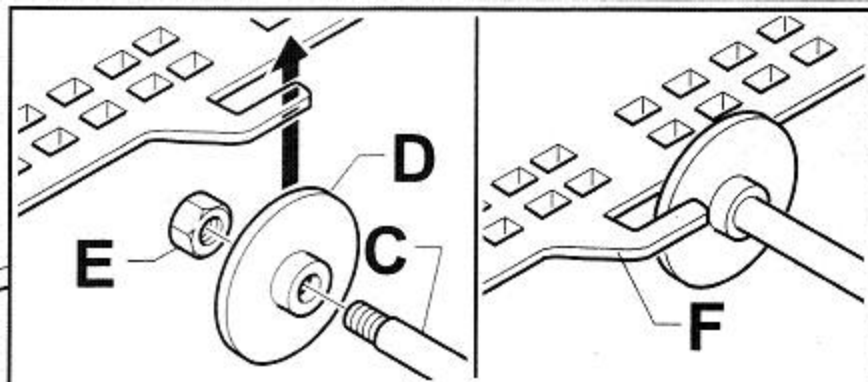
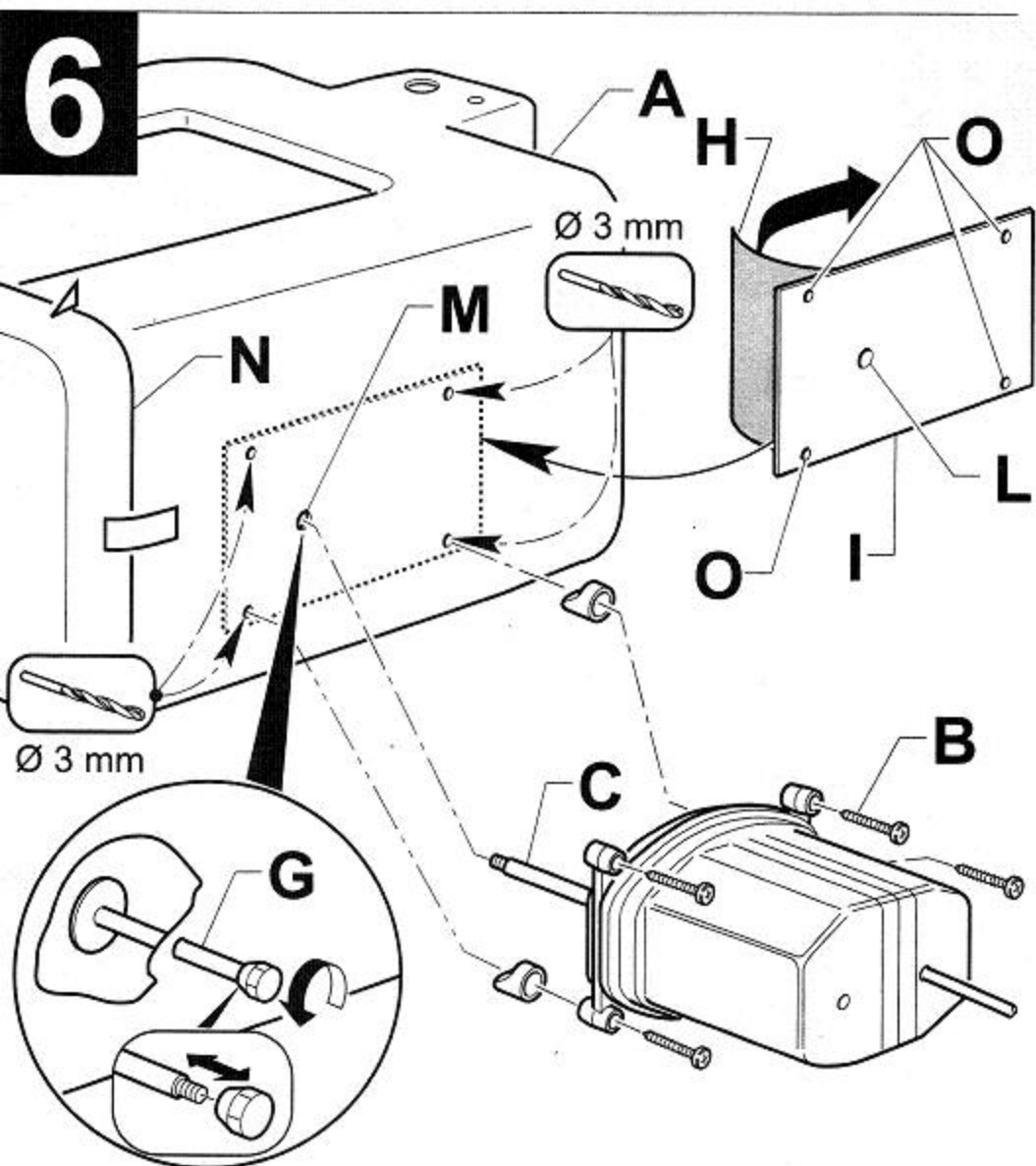
5**6**

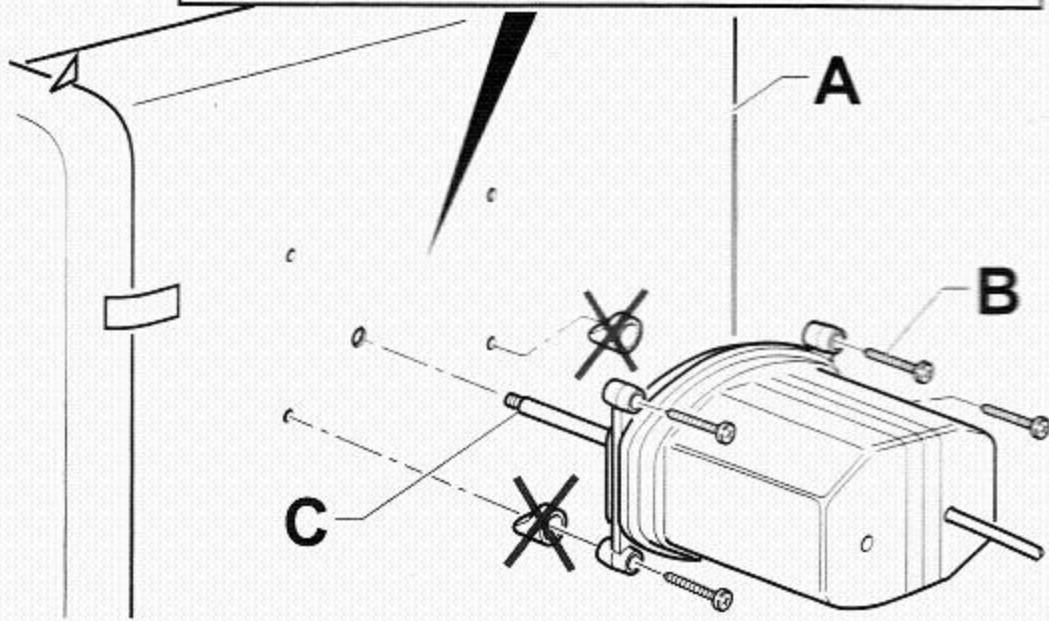
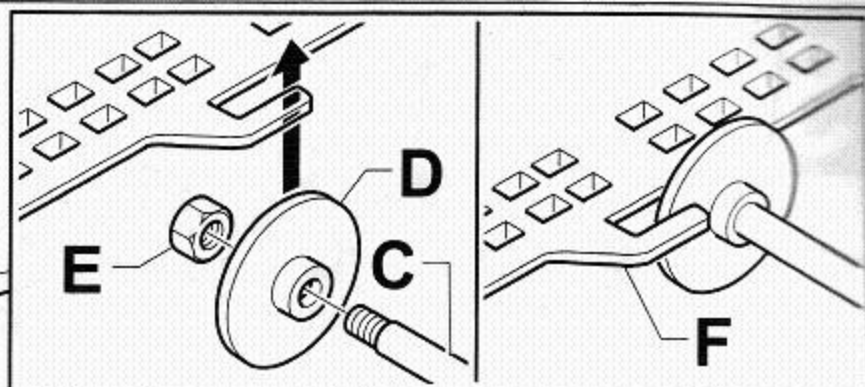
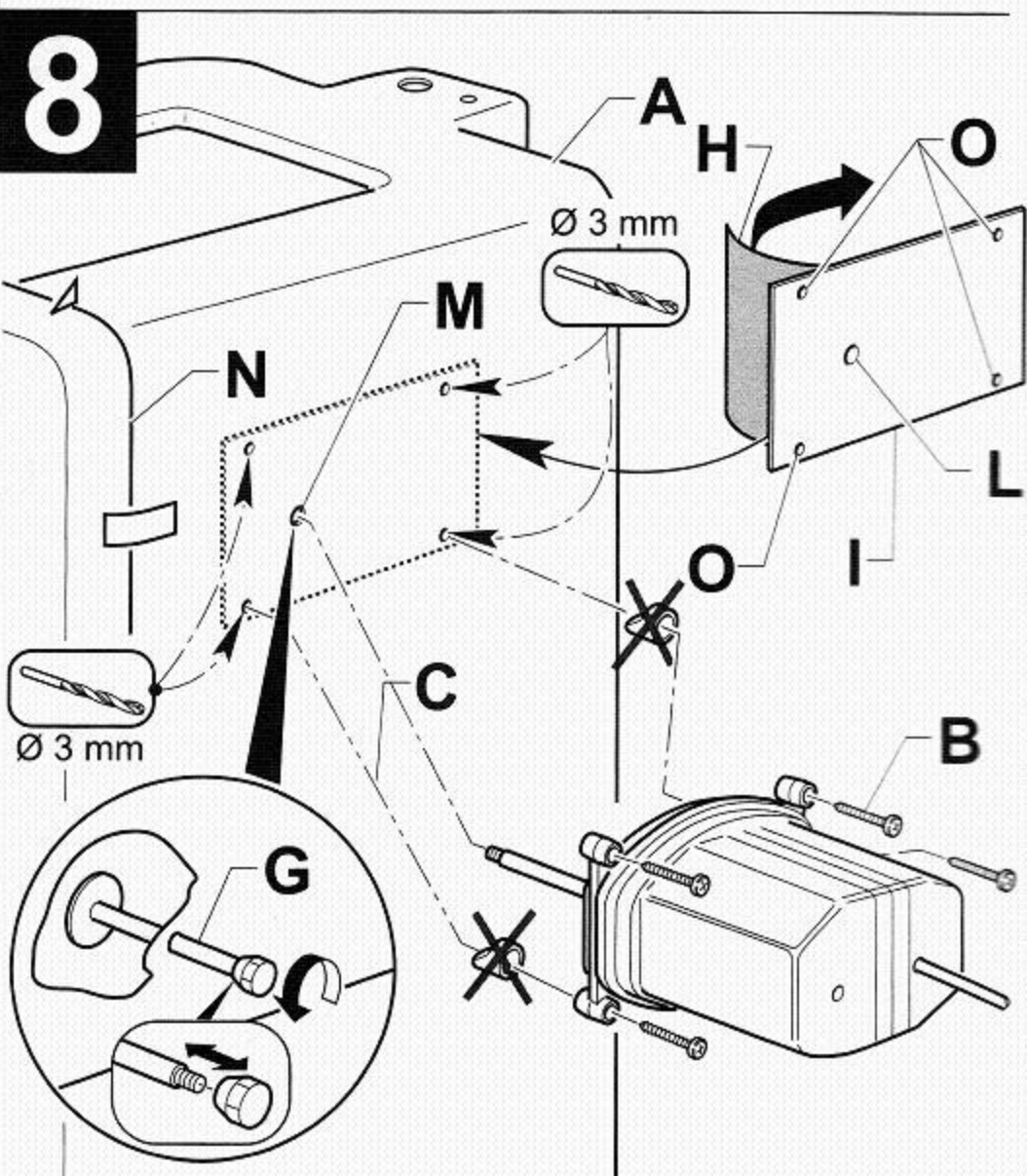
7**8**

AUTOMATIC EGG-TURNING DEVICE



INSTRUCTIONS FOR USE

The AUTOMATIC EGG-TURNING DEVICE allows to turn the eggs 'automatically'.

Available in different models, it can be installed to all NOVITAL incubators, provided the manual egg turning device is already applied, despite of the manufacturing time.

The AUTOMATIC EGG-TURNING DEVICE can be installed both to incubators already prearranged for its installation and the ones originally supplied with half automatic egg-turning device only.

This automatic system prevents some unpleasant situations that might occur during the incubation process, especially during the first seven days, i.e. the most critical period for embryo development. Indeed, the automatic egg-turning device allows to turn the eggs constantly, in the course of time, thus preventing the embryo from touching the shell, which would eventually cause calcification and therefore death. Moreover, it prevents the eggs from being subjected to violent collisions, otherwise caused by accidental wrong manual turning or even carelessness. Hence, thanks to this device, the user can avoid intervening on the egg-turning operation twice a day (morning and evening).

AUTOMATIC EGG-TURNING DEVICE PREPARATION

PLEASE READ ALL THE INSTRUCTIONS CAREFULLY BEFORE STARTING THE MACHINE

Please be aware this machine is to be used for the above mentioned purpose only. If used differently, it is considered to be dangerous and the Manufacturing Company rejects all responsibility for any eventual damage to people, animals or/and things, resulting from inobservance of this warning.

Remove the machine from its packaging and make sure nothing is missing or damaged. Please do not scatter the parts used for the packaging in the environment; also keep both the packaging and the machine away from the reach of children as well as minors, incapable people and/or animals.

Please verify that all machine parts are well fastened and in the right place, then, before assembling it, check that the machine plate data are suitable for the rated mains voltage and the power available in the room.

AUTOMATIC EGG-TURNING DEVICE INSTALLATION:

• **COVATUTTO "20" and "24 Eco"** already predisposed for automatic egg-turning device installation - See picture 1

a) Should the incubator have already been prearranged for the application of the AUTOMATIC EGG-TURNING DEVICE, it would be enough to separate unit (A) from the parts of the incubator that constitute obstacles and follow the instructions shown in picture 1. Remove the tie rod (G) in order to turn the eggs manually. Install and lock the parts in the proper way by using the accessories the machine is equipped with, making sure to fasten the four self threaded screws (B) by turning them only for one eighth loop only, i.e. from the moment in which the whole is locked against the face of the incubator unit. Then, remove the hexagonal nut (C) from the sliding bottom (D), hook the pulling bottom (E) by means of the "hook" obtained by screwing (F) with the spacer (K) in the hole (S) and carefully avoiding the other hole (T) and reassemble the incubator for use.

• **COVATUTTO "20" and "24 Eco"** - not predisposed for automatic egg-turning device installation - See picture 2

b) Should the incubator have not already been prearranged for the application of the AUTOMATIC EGG-TURNING DEVICE, you would need

to separate unit (A) from the parts of the incubator that constitute obstacles and follow the instructions described within pic.2. Remove the tie rod (G) used to turn the eggs manually; remove the strip(H) from the adhesive part of the of the sheet to be 'perforated' (I). Place the "sheet" by fixing the centre of the hole (P) with the hole of the manual tie rod (M) already on the unit.

Keep the edge of the "sheet"(I) parallel to the unit edge(N), stick the "sheet" to the unit and drill it in the four points(R), using a 3mm diameter drill; ultimately, unstick the "sheet" and install the "AUTOMATIC EGG-TURNING DEVICE" to the unit referring to the other dispositions shown at point "a" and in Picture 1.

• **COVATUTTO "20+20"** - already predisposed for automatic egg-turning device installation - See picture 3

c) Should the incubator have already been prearranged for the application of the AUTOMATIC EGG-TURNING DEVICE, it would be enough to separate unit (A) from the parts of the incubator constituting obstacles and follow the instructions shown in picture 3. Install and lock the parts in the proper way by using the accessories the machine is equipped with, making sure to fasten the four self threaded screws

(B) by turning them only for one eighth from the moment in which they start locking the whole against the face of the incubator unit. Then, screw the small disk (D) to the tie rod (C) after having placed the hexagonal nut (E). Finally, hook the sliding bottom (F) of the egg-holder drawer and reassemble the incubator for use.

• **COVATUTTO "20+20"** - not predisposed for automatic egg-turning device installation - See picture 4

d) Should the incubator have not already been prearranged for the application of the AUTOMATIC EGG-TURNING DEVICE, you would need to separate unit (A) from the parts of the incubator that constitute obstacles and follow the instructions described within pic.4. Remove the tie rod (G) used to turn the eggs manually; remove the strip(H) from the adhesive part of the of the sheet to be 'perforated' (I). Place the "sheet" by fixing the centre of the hole (P) with the hole of the manual tie rod (M) already on the unit. Keep the edge of the "sheet"(I) parallel to the unit edge(N), stick the "sheet" to the unit and drill it in the four points(R), using a 3mm diameter drill; ultimately, unstick the "sheet" and install the "AUTOMATIC EGG-TURNING DEVICE" to the unit referring to the other dispositions shown at point "c" and in Picture 3.

• **COVATUTTO "40" and "40-4V"** - already predisposed for automatic egg-turning device installation - See picture 5

e) Should the incubator have already been prearranged for the application of the AUTOMATIC EGG-TURNING DEVICE, it would be enough to separate unit (A) from the parts of the incubator constituting obstacles and follow the instructions shown in picture 5. Install and lock the parts in the proper way by using the accessories the machine is equipped with, making sure to fasten the four self threaded screws (B) by turning them only for one eighth from the moment in which they start locking the whole against the face of the incubator unit. Then, screw the small disk (D) to the tie rod (C) after having placed the hexagonal nut (E). Finally, hook the sliding bottom (F) of the egg-holder drawer and reassemble the incubator for use.

• **COVATUTTO "40" AND "40-4v"** - not predisposed for automatic egg-turning device installation - See picture 6

f) Should the incubator have not already been prearranged for the application of the AUTOMATIC EGG-TURNING DEVICE, you would need to separate unit (A) from the parts of the incubator that constitute obstacles and follow the instructions described within pic.6. Remove the tie rod (G) used to turn the eggs manually; remove the strip(H) from the adhesive part of the of the sheet to be 'perforated' (I). Place the "sheet" by fixing the centre of the hole (P) with the hole of the manual tie rod (M) already on the unit. Keep the edge of the "sheet"(I) parallel to the unit edge(N),

stick the "sheet" to the unit and drill it in the four points(R), using a 10mm diameter drill; ultimately, unstick the "sheet" and install the "AUTOMATIC EGG-TURNING DEVICE" to the unit referring to the dispositions shown at point "e" and in Picture 5.

• **COVATUTTO "120" and "120-4V"** - already predisposed for automatic egg-turning device installation - See picture 7

g) Should the incubator have already been prearranged for the application of the three AUTOMATIC EGG-TURNING DEVICES, it would be enough to separate unit (A) from the parts of the incubator constituting obstacles and follow the instructions shown in picture 7. Install and lock the parts in the proper way by using the accessories the machine is equipped with, making sure to fasten the four self threaded screws (B) by turning them only for one eighth loop only, i.e. from the moment in which they start locking the whole against the face of the incubator unit. Then, screw the small disk (D) to the tie rod (C) after having placed the hexagonal nut (E). Finally, hook the sliding bottom (F) of the egg-holder drawer and reassemble the incubator for use.

As this incubator model enables you to incubate the eggs continuously (see instructions for incubator use), the three AUTOMATIC EGG-TURNING DEVICES are independent from each other so that they can be activated or/and deactivated singularly by means of their relevant feeder cable so that to grant the egg turning process in each one of the egg-holder drawers or not.

• **COVATUTTO "120" and "120-4V"** - not predisposed for automatic egg-turning device installation - See picture 8

h) Should the incubator have not already been prearranged for the application of the AUTOMATIC EGG-TURNING DEVICE, you would need to separate unit (A) from the parts of the incubator that constitute obstacles and follow the instructions described within pic.8. Remove the tie rod (G) used to turn the eggs manually; remove the strip(H) from the adhesive part of the of the sheet to be 'perforated' (I). Place the "sheet" by fixing the centre of the hole (P) with the hole of the manual tie rod (M) already on the unit. Keep the edge of the "sheet"(I) parallel to the unit edge(N), stick the "sheet" to the unit and drill it in the four points(R), using a 10mm diameter drill; ultimately, unstick the "sheet" and install the "AUTOMATIC EGG-TURNING DEVICE" to the unit referring to the other dispositions shown at point "G" and in Picture 7.

• **COVATUTTO "24" and "54"** - already predisposed for automatic egg-turning device installation - See picture 9

i) Should the incubator have already been prearranged for the application of the AUTOMATIC EGG-TURNING DEVICE, it would be enough to separate unit (A) from the parts of the incubator that constitute obstacles and follow the instructions shown in picture 9. Install and lock the parts in the proper way by using the accessories the machine is equipped with, making sure to fasten the four self threaded screws (B) by turning them only for one eighth loop only, i.e. from the moment in which the whole is locked against the face of the incubator unit. Then, remove the hexagonal nut (C) from the sliding bottom (D), hook the pulling bottom (E) by means of the "hook" obtained by screwing (F) with the spacer (K) in the hole (S) and carefully avoiding the other hole (T) and reassemble the incubator for use.

• **COVATUTTO "24" and "54"** - not predisposed for automatic egg-turning device installation - See picture 10

l) Should the incubator have not already been prearranged for the application of the AUTOMATIC EGG-TURNING DEVICE, you would need to separate unit (A) from the parts of the incubator that constitute obstacles and follow the instructions described within pic.10. Remove the tie rod (G) used to turn the eggs manually; remove the strip(H) from the adhesive part of the of the sheet to be 'perforated' (I). Place the "sheet" by fixing the centre of the hole (P) with the hole of the manual tie rod (M) already on the unit. Keep the edge of the "sheet"(I) parallel to the unit edge(N),

stick the "sheet" to the unit and drill it in the four points(R), using a 3mm diameter drill; ultimately, unstick the "sheet" and install the "AUTOMATIC EGG-TURNING DEVICE" to the unit referring to the other dispositions shown at point "i" and in Picture 9.

USEFUL INSTRUCTIONS

After having applied the AUTOMATIC EGG-TURNING DEVICE to the incubator and before plugging in and activate the machine, always move the tie rod (C) or (E) manually and slightly to and fro from the outside to make sure there is a slight clearance and and it is free to move in its seat. Eventual problems are to be related to an incorrect and forced application to the incubator.

The correct functioning of the AUTOMATIC EGG-TURNING DEVICE can be verified by observing the tie rod (C) or (E) in comparison to the machine: in fact, it always reaches the same position every two hours ca. A! All incubators supplied with an AUTOMATIC EGG-TURNING DEVICE are equipped with the proper accessories for the MANUAL EGG-TURNING DEVICE, which are not to be used.

Please, now follow the instructions each incubator model is provided with.

WARNINGS

- As this is an electronic device, make sure not to touch it with wet hands or bare feet.
- This machine is to be used indoors only. Eventual water jets might cause an electric shock.
- Avoid using improper extensions, always keep connections dry and do not damage the feeder.
- Under no circumstances, the machine has to be used in unsafe places, where the saturation with inflammable gases may occur or get mixed with different liquids and/or inflammable substances.
- Cleaning and maintenance should be done with a clean cloth and/or brushes, avoiding the use of tools or liquids; dusts can be removed with a gentle air jet. Always remember to unplug the machine before carrying out these operations.
- Maintenance should be limited to usual periodic inspections (before the use) of the moving parts and of the feeder, in order to establish if they are damaged or worn.
- Other cleaning and/or maintenance operations shall be carried out by qualified personnel of an authorised Service Centre or Novital only.
- Never move the machine by pulling the its feeder. Always unplug the device from the main electric net supplier before moving it anywhere.
- Should the machine need repairing, including a feeder replacement, please apply to qualified personnel of an authorised Service Centre or Novital only.
- In case of fire, make sure you use powder extinguishers, as usually advised when dealing with electric devices. NEVER use water as electrocutions might occur.
- Should the machine be proved to be out of order, it will have to be made idle by cutting the feeder as much close as possible to the machine output point, after having unplug the machine itself. Only after having carried out this operation you are allowed to dump the broken machine to an authorised tip.